

MOUNTING HOLES

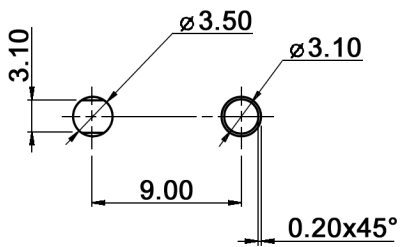

CIRCUIT DIAGRAM

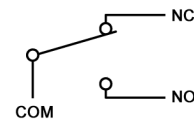

Compliance: RohS III (2015/863/EU)

Tolerances: ±0.40 mm	Date	Name
		02/20
Modifications	Date	Name

DM-DW 1 L 03 P 15

knitter-switch

30 43 61

Page

1/2

Specifications:

Contact rating: 0.1 A, 48 V DC, 125/250 V AC
 3 A, 12 V DC
 μ40T85 1E5
Insulation resistance: 100 MOhm min. at 500 V DC for 1 minute +/-5 sec.
Dielectric strength: 1000 V (50/60 Hz, 10 mA) for 1 minute +/-5 sec.
Operating temperature: -40°C to +85°C
Mechanical life: 500 000 cycles
Electrical life: 100 000 cycles
Operating force: 250 gf max.
Release force: 50 gf min.
Soldering conditions: iron method: 350 +/-5°C, 3 +/-0.5 sec.
Differential travel: 1.10 mm max.
Over travel: 0.50 mm min.
Sealing protection: IP67
Material: Cover / case: PA
 Plunger: POM
 Terminals: Cu alloy, silver plated
 Moving plate: Cu alloy, silver plated
 Internal lever: SUS
 Contact: silver alloy
 Lever: SUS
 Gasket: silicone rubber

Compliance: RohS III (2015/863/EU)

Tolerances: ±0.40 mm	Date	Name	DM-DW 1 L 03 P 15
	02/20	dr	
			30 43 61
			Page
			2/2
Modifications	Date	Name	